

# Dispatch automation for the cement industry

## example for application

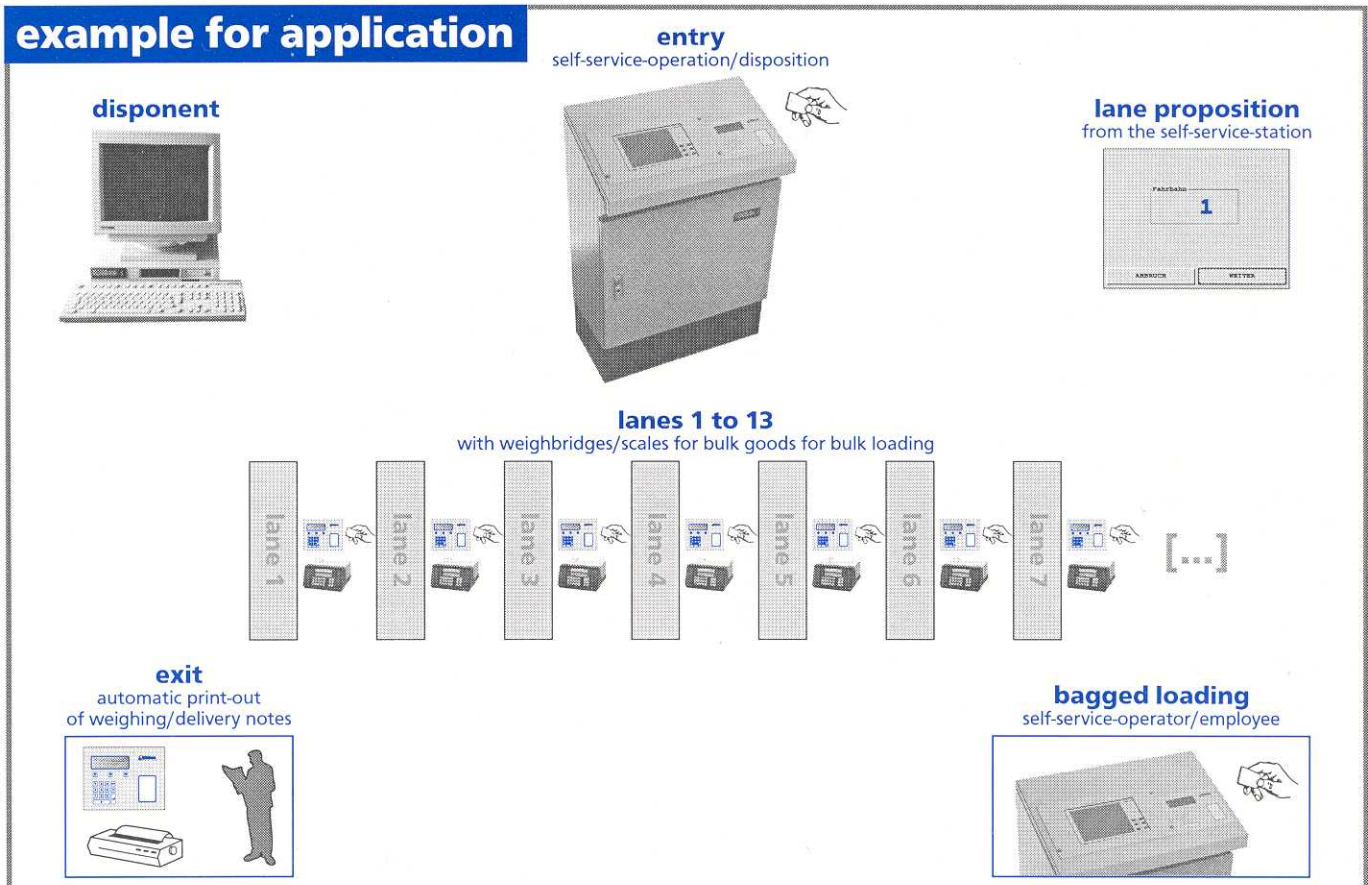

## Application

With the dispatch automation system of BITZER, the weighing and loading of bulk and bagged cement is carried out, as well as the completion of the delivery of additives.

The system structure is modular. Due to a most modern client-server-architecture (Windows NT, SQL-data bank, programming that is orientated to the object) it is possible without any problems to expand the system by e.g. further clients or integration of further scales for e.g. bulk loading or bagged loading.

Standardised and expandable software modules as well as configurable functions make it possible to

carry out adjustments corresponding to the customer's needs.

The connection to the central administration is made via ISDN. The system provides interfaces to superior EDP-systems e.g. SAP and/or to disposition computers of e.g. forwarders.

By means of self-service stations with touch-screen-computers, the truck drivers are able to do the disposition and loading by themselves.

A comfortable emergency operation increases the availability and ensures that a delivery note is printed even if there is a network breakdown - so, the trucks can leave the factory even in case of trouble.

